

● NOMENCLATURE

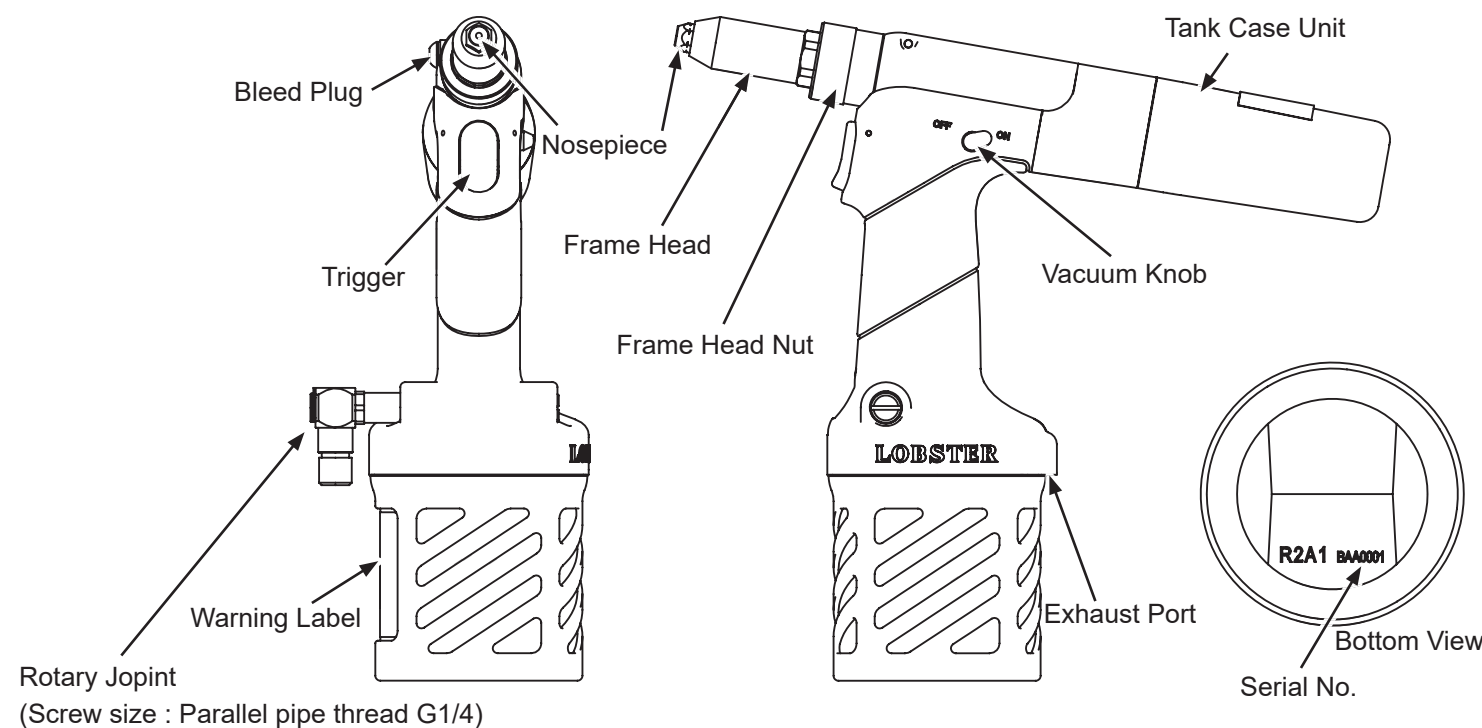

* Serial No. is displayed by the abbreviation of the date of manufacture (three letters of the alphabet) and four-digit number.

◇ How to check manufactured date

A year/month of manufacture	1	2	3	4	5	6	7	8	9	10	11	12
An English character	A	B	M	N	K	W	T	Y	U	O	L	Z

(Example)year: 2020 month:10 → BOO OOOO
 B O O (Lot No.)

● CONTENTS

Verify that the items listed below are included. If any items are missing or damaged, please contact the retailer where you purchased the product.

Depending on the product, there may be notes in the packaging that are not listed below. Refer to them when using or maintaining the product.

R2A1

1. Air Riveter R2A1
(Nosepiece 3.2, Guide Pipe Unit 2.4-3.2)

2. Easy Guide (this manual)
Japanese, English 1ea

3. Tank Case Unit

4. Nosepiece 2.4, 4.0, 4.8

5. Guide Pipe Collar 4.0-4.8
(with O-ring)

6. "LOBSTER" Lubricant Oil

R2A2

1. Air Riveter R2A2
(Nosepiece 6.4)

2. Easy Guide (this manual)
Japanese, English 1ea

3. Tank Case Unit

4. Nosepiece 4.8

5. "LOBSTER" Lubricant Oil



EASY GUIDE AIR RIVETER R2A1/R2A2



Thank you very much for purchasing "LOBSTER" air riveter.

Instruction Manual

The instruction manual is not included with the product. To ensure correct operation, please carefully read the Easy Guide (this manual) and the Instruction Manual available on the following Website and store them for later reference.

<http://www.lobtex.co.jp/english/products/tabid/153/pdid/E-R2A1/catid/108/Default.aspx>



For smartphone

● INTRODUCTION

- These are the blind rivet tools which are only used for fixing blind rivets. These tools are not designed for other purposes.
- Please check the blind rivets specification and durability on customers side before using it.

1 EASY GUIDE and INSTRUCTION MANUAL

- The instructions for use of these tools are divided into this manual and instruction manual. Please refer to this manual or instruction manual according to the information you need.

Contents of
Easy Guide

- IMPORTANT SAFETY INSTRUCTIONS
- NOMENCLATURE
- CONTENTS

Contents of
Instruction Manual

- EASY GUIDE (this manual)
- TECHNICAL DATA
- PREPARATION BEFORE USE
- OPERATING THE AIR RIVETER
- MAINTENANCE
- TROUBLESHOOTING
- EXPLODED VIEW
- PARTS TABLE
- STORAGE
- ORDERING PARTS

2 IMPORTANT NOTICES

- Read this manual and Instruction Manual carefully before using this tool. Follow instructions in Instruction Manual for handling this tool, replacing accessories or replacing parts as needed.
- If you have any questions about this manual and Instruction Manual, contact the "LOBSTER" dealer where you purchased the tool.
- It is impossible to foresee all potential dangers and describe them in this manual and Instruction Manual. You must operate this tool paying attention to safety as well as observing the instructions in this manual and Instruction Manual.
- This manual and Instruction Manual are translated from Japanese, its original language. It is your own responsibility to achieve a full understanding of the contents of this manual and Instruction Manual before using the equipment described.
- Lobtex Co., Ltd. has the copyright of this manual and Instruction Manual. These are prohibited to publish, copy or translate to other language without prior consent.

3 DISCLAIMER

- Our warranty does not apply to direct and indirect damages and lost income caused by the misuse, abuse, and unauthorized modification of the tool. We do not guarantee the strength or quality of blind rivet.
- We do not guarantee any damages and failures caused by any modifications without our written approval.
- We do not guarantee any damages and failures caused by use of parts other than our recommendation.

MANUFACTURER
LOBTEX CO., LTD.
 International Marketing&Sales Division
 12-8 Shijo-cho, Higashi-Osaka City
 Osaka 579-8053, Japan

Telephone: +81(72)981-7466
 Telefacts: +81(72)981-9420
 URL <http://www.lobtex.co.jp/>

PRINTED IN JAPAN
 Published in Dec. 2023
 No .RAR2A1S90122

● IMPORTANT SAFETY INSTRUCTIONS



- ◆ Be sure to read the following Important Safety Instructions and make sure that you understand them thoroughly before using this tool.



- ◆ Always wear protective goggles while using the tool. The blind rivets may jump out by accident and cause injuries.



- ◆ This is the safety alert symbol. It is used to alert you to potential personal injury hazards. Obey all safety messages that follow this symbol to avoid possible injury or death.

Description of signs



WARNING

Indicates a potentially hazardous situation which, if ignored, may result in death or serious injury to the operator.



CAUTION

Indicates a potentially hazardous situation which, if ignored, may result in moderate injury to the operator or physical damage.

Moreover, even if the items are listed in the **CAUTION**, there could be serious results in some cases. Always be sure to observe the instructions given in the Important Safety Instructions.

- ◆ After reading this manual, keep it in a safe place where it is easily accessible to all users.



WARNING

1.The air pressure should be kept within the range of 0.5 to 0.6 MPa.

- If an air pressure which is greater than this is used, the tool may become damaged, and injury or damage to property may result.

2.Never look into the Nosepiece of the tool, and never point the Nosepiece toward other persons.

- If the tool is used while the cut mandrels are still inside the tool not being ejected, these mandrels may be ejected from the tool's Nosepiece during use and cause serious injury.

3.Always attach the Tank Case Unit before use.

- If you work without attaching the tank case unit, there is a risk that the mandrel of blind rivet that has been cut is not discharged, and will be clogged inside exhaust pipe,causing a fault of the equipment. Also, these mandrels may be ejected from the tool's nosepiece during use and cause serious injury.

4.Wear protective glasses during use.

- Failure to do so may result in an accident or personal injury in case that a blind rivet or a piece of cut-mandrels jumps out toward you.

5.Make sure that the tool and the air source are connected securely.

- If the threads of the Rotary Joints do not match or if the screws are not inserted far enough, the air hose may become disconnected during use and injury may result.
- Use hose bands to securely connect the air hose joint and air hose. If they are not connected securely enough, the air hose may become disconnected during use and injury may result.

6.Turn off the air supply before disconnecting the tool from the air source.

- Compressed air may cause the air hose to whip around, and injury may result.

7.Check that all the tool parts are free from damage before use. Any damaged parts should be repaired before the tool is used.

- If the tool is used while any parts are still damaged, injury may result.
- If the tool is damaged by objects being dropped onto it, for instance, the damaged part may break and accident or injury may result.
- Don't pull and drag the tool by the air hose. It may trigger some damages on the tool body, breakage of Rotary Joint or some other defects and lead serious troubles with injuries.

8.If using in elevated locations, use a safety harness, and take care to avoid dropping blind rivets or the tool itself.

- Accident or injury may result if this practice is not followed.



CAUTION

1.Before starting maintenance or disassembling the unit to replace parts, be sure to stop air supply.

- Performing maintenance or disassembly with air supplied may cause a part to jump out, oil to squirt out, or the unit to perform unexpected behavior, and may result in an accident or personal injury.

2.Tighten the Bleed Plug firmly before use.

- If the Bleed Plug is loose or coming off during use, oil may squirt out resulting in an accident or personal injury.



CAUTION

3.Do not operate the tool with the Frame Head removed.

- Items such as fingers may become caught in the mechanism.

4.Do not bring your face close to the exhaust ports.

- Pressurized air containing fine particles is discharged from the exhaust ports during use. Keep eyes away from this area.

5.Avoid skin contact with substances such as hydraulic oil, lubricating oil and grease.

- Such substances may cause inflammation of the skin. If they come into contact with your skin, wash the affected area thoroughly.

6.The parts to be used must be those supplied from us or recommended by us. Select and attach parts applicable to your blind rivet.

- Otherwise the unit may not produce maximum performance and may sometimes malfunction resulting in an accident or personal injury.

7.Make sure that the workplace is safe, clean and organized.

- Accidents can easily occur in untidy workplaces.
- If the cut mandrels are allowed to fall onto the floor, you may slip on them, and injury may result.

8.Avoid uncomfortable postures while working.

- You may fall down and injury may result.

9.Keep people who are not involved in work away from the workplace.

- Accidents or injury may result.

10.Maintain the tool with due care.

- Refer to the Instruction Manual for details on replacing parts and attachments, otherwise injury may occur.

11.Keep the handgrip always dry and clean, and avoid adhesion of oil and grease.

- Otherwise the grip may slip from your hand resulting in falling of the unit.

12.Do not leave the floor littered with cut-mandrels.

- Cut mandrels are dangerous because their ends are sharp. Stepping on them is also dangerous easily causing a slip and fall accident.

13.Ask Lobtex to carry out any repair work required.

- Repair work should only be carried out by a qualified technician. Please contact your nearest “LOBSTER” distributor, representative, or direct to Lobtex Co., Ltd., Osaka. If the tool is repaired by someone without the necessary qualifications and experience, the tool may not perform to optimum standards, and accidents or injury may result.

14.Do not attempt to modify the tool.

- Unauthorized modifications may cause malfunctions which can lead to accidents or injury.

15.Only qualified and trained operators should install, adjust or use the assembly power tool for non-threaded mechanical fasteners.

16.When disposing this tool, please follow the regulations and the rules of the country and autonomous community.

17.Important information and clue about the use are listed in Warning Label. When contents cannot read by contamination or by the damage of the label, please order a new label and put it.

- The new label could be ordered from us(Lobtex) via distributor.

18.This product is a tool for exclusive use of the professional business. When you are the one who uses this tools for the first time, please receive an instruction from the one who have already used this tools before, also please read the Instruction Manual carefully and understand the content.

- Wear protective goggles or safety glasses.
- When this product is damaged, please do not use.

19.This product is an exclusive tool for blind rivet fastening two boards by riveting. We do not design, manufacture or sell intending to other applications.

20.Please perform regular inspection and maintenance on this machine. As a guideline, inspect fastening every 30,000 blind rivets or once a year, and request repair if any abnormality is suspected.

21.Slips, trips and falls are major causes of workplace injury. Be aware of slippery surfaces caused by use of the tool and also of trip hazards caused by the air line or hydraulic hose.

22.Proceed with care in unfamiliar surroundings. There can be hidden hazards, such as electricity or other utility lines.

- You may fall down and injury may result.

23.This assembly power tool is not intended for use in potentially explosive atmospheres.

24.This assembly power tool is not insulated against contact with electric power.

25.Ensure that there are no electrical cables, gas pipes, etc.,which can cause a hazard if damaged by use of the tool.

26.If you experience numbness, tingling, pain or whitening of the skin in your fingers or hands, stop using the assembly power tool, tell your employer and consult a physician.

27.Air under pressure can cause severe injury.

- Always shut off air supply, drain hose of air pressure and disconnect tool from air supply when not in use, before changing accessories or when making repairs.
- Never direct air at yourself or anyone else.

28.Always check for damaged or loose hoses and fittings.

- Whipping hoses can cause severe injury.

29.Handle this product in a careful manner.

- Rough handling may cause an accident and failure of the tool. Do not throw, drop, nor give shock to this product.

30.Do not carry nor trail this product by pulling a joint hose.

- It may cause a damage to the hose, a failure and an abnormal action of this product. Then, an accident and injury may result.

31.The regular preventative maintenance shall be carried out, for instance after a speciflied time of operation, a specified number of cycles/operations or a stated number of times per year.

33.When you handle hydraulic oil or grease, obtain the Safety Data Sheet (SDS) from the supplier, and follow the described instructions.

34.Only for EU countries, do not dispose of electric tools together with household waste material !

- In observance of European Directive 2002/96/EC on waste electrical and electronic equipment and its implementation in accordance with national law, electric tools that have reached the end of their life must be collected separately and returned to an environmentally compatible recycling facility.